

TT55D INSTRUCTION SHEET

SPECIAL FEATURES

- Hand Operated
- Strong, durable and compact design
- Light weight

APPLICATIONS

The hardy yet light weight TT55D is ideal for on-site or low production use.

DESCRIPTION OF MECHANISM

The mandrel gripping mechanism consists of twin jaws (PO25278) which are fitted into a Jaw Case (PO25270). This is screwed into the Inner Barrel (PO25272) which engages with the Lever (PO25264). Movement of this lever operates the Inner Barrel backwards and forwards. The Jaw Pusher (PO25274) and Spring (PO25276) keeps the jaw in the forward position.

OPERATING INSTRUCTIONS

Please Note: When operating this tool appropriate eye protection must be worn.

1. Open the Lever (PO25264)
2. Insert the mandrel through the nose piece (PO25280/2/4)
3. Insert "POP" Rivet into the hole
4. Squeeze the Lever until the mandrel of the "POP" Rivet snap.
5. The re-opening of the jaws release the broken mandrel allowing it to be discarded
6. It is important to ensure that the broken mandrel is removed from the tool before attempting to insert the next rivet into the tool.

MAINTENANCE

A few light drops of machine oil should be used to lubricate the working mechanism weekly or every 3,000 Rivets (whichever comes first). The Jaws should be removed and cleaned every 3,000 Rivets as follows:

1. Remove R Clip (PO25268)
2. Slide out Fulcrum Pin (PO25266)
3. Detaching the Lever (PO25264) will allow the Inner Barrel (PO25272) to be withdrawn from the Body (PO25262)
4. Using spanners (PO25260) unscrew the Jaw Case (PO25270) from the Inner Barrel (PO25272)
5. The Jaws are now free for cleaning or replacement. When re-assembling the Jaw Case (PO25270) must be locked tight onto the Inner Barrel (PO25272).

DIMENSIONS

OVERALL LENGTH: 229mm

WEIGHT: 0.4kg

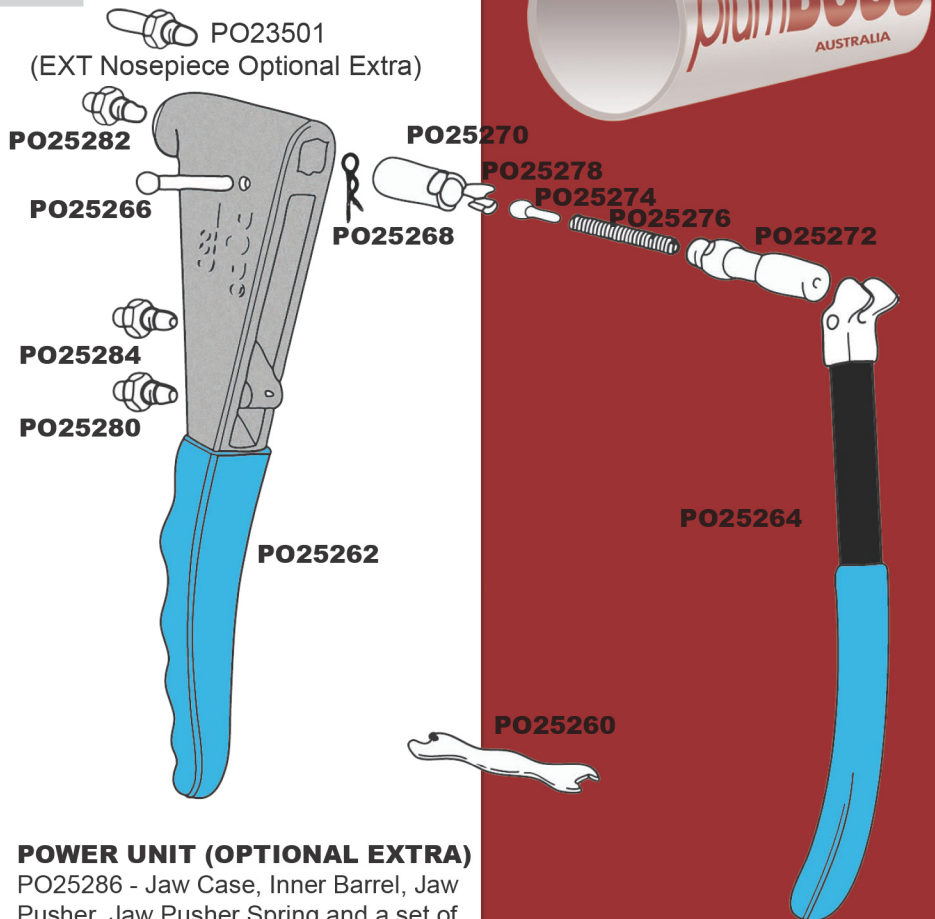
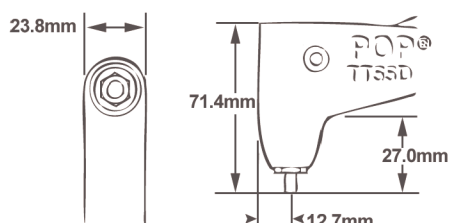

POWER UNIT (OPTIONAL EXTRA)

PO25286 - Jaw Case, Inner Barrel, Jaw Pusher, Jaw Pusher Spring and a set of Jaws, supplied complete and assembled.



NUMBER	QTY	DESCRIPTION
PO25260	2	Spanners for Jaw Case
PO25262	1	Pliers Body
PO25264	1	Pliers Lever
PO25266	1	Fulcrum Pin
PO25268	1	Fulcrum Pin R Clip
PO25270	1	Jaw Case
PO25272	1	Inner Barrel
PO25274	1	Jaw Pusher
PO25276	1	Jaw Pusher Spring
PO25278	1	Jaws (Set of 2)
PO25280	1	Nosepiece, 3.2mm (1/8\"/>

PRODUCT DATA

- Sets steel monel and aluminium alloy "POP" Standard Open Type and "POP" Closed End rivets 2.4mm (3/32") and 3.2mm (1/8") dia.
- With simple conversion can set "POP" Rivets with aluminium alloy or steel "POP" standard Open Type Rivets up to 4mm (5/32") dia.



Nosepiece PO25280 for 2.4mm (3/32") Standard Open Rivets and 3.2mm (1/8") Closed End Rivets.

Nosepiece PO25282 for 2.4mm (3/32") Standard Open Rivets.

Nosepiece PO25284 for 4mm (3/32") Alum. Alloy Standard Open Grooved Rivets.

plumBOSS AUSTRALIA
53 Taylor Street, Bulimba, QLD, 4171
P:(07) 3373 3500 F:(07) 3373 3533
E: info@plumboss.com.au
W: www.plumboss.com.au