

Operating Instructions

REX RB Tube Cutter Model N30P

Code No.
427830

For Coated and Nude Copper Pipes

For safe, efficient use, read these instructions carefully before use. Use the device correctly and for its intended use only. Keep these instructions in a safe place so that you can refer to them at any time.

⚠ WARNING

- Use the cutter only for the types of tubes described in these instructions. Use with other pipes, or for purposes other than the intended use, may result in an accident or damage to the cutter.
- Always inspect the cutter before use. If you find anything wrong, do not use until repairs have been made.
- When cutting pipes, make sure the blade doesn't touch your hand. Never place your fingers between the blade and the pipe.
- Avoid dropping the cutter either when using or carrying it.
- Be sure to remove any water or flux from the cutter. Failure to do so could result in the bearings becoming rusty and malfunctioning.

■ Instructions

- 1 Place the pipe on the cutter between the rollers and the blade as shown in Fig. 1. When doing so, make sure the end of the pipe protrudes further than the width of the rollers. Once the blade engages the pipe, turn the grip clockwise again 1/4 of a turn.

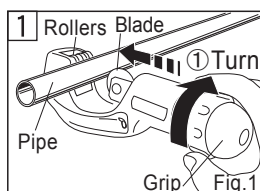

- 2 Rotate the cutter back and forth 2 or 3 times through 90° (see Fig.4 on reverse side) then fully one time to make a cutting guideline.

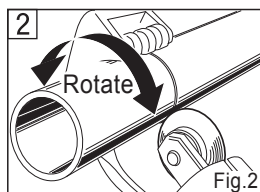

- 3 Then turn the grip slowly, (1/8 of a turn for every 3 or 4 rotations of the cutter) and keep rotating the cutter as you gradually cut deeper into the pipe.

- Avoid cutting too quickly or the pipe may become distorted and the life of the blades reduced.
- By attaching a special blade (sold separately) you can also cut copper (annealed or unannealed) and brass pipes.

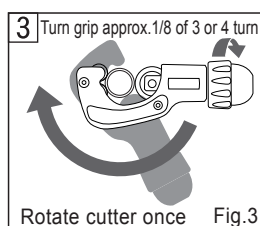

■ Specifications

Application	Coated and Nude Copper Pipes
Cutting capacity	External Diam. 5 - 34 mm
Weight (main unit)	350g
Blade diameter	φ32
Rollers	625ZZ
Spare Blade Code No.	424237
Optional Extras	Blade for Thin wall Stainless Steel Pipes (Code No.424233, 424284)

REX INDUSTRIES CO.,LTD.

Overseas Sales Dept. & Factory

1-9-3, Hishiya-Higashi, Higashi-Osaka 578-0948 Japan
Tel. +81-(0)72-961-9820 Fax +81-(0)72-961-9878
www.rexind.co.jp

4V440-E2
1304D01000

Operating Instructions

REX RB Tube Cutter Model N30S

Code No.
427630

For Thin wall Stainless Steel Pipes

For safe, efficient use, read these instructions carefully before use. Use the device correctly and for its intended use only. Keep these instructions in a safe place so that you can refer to them at any time.

⚠ WARNING

- Use the cutter only for the types of tubes described in these instructions. Use with other pipes, or for purposes other than the intended use, may result in an accident or damage to the cutter.
- Always inspect the cutter before use. If you find anything wrong, do not use until repairs have been made.
- When cutting pipes, make sure the blade doesn't touch your hand. Never place your fingers between the blade and the pipe.
- Avoid dropping the cutter either when using or carrying it.
- Be sure to remove any water or flux from the cutter. Failure to do so could result in the bearings becoming rusty and malfunctioning.

■ Instructions

- 1 Place the pipe on the cutter between the rollers and the blade as shown in Fig. 1. When doing so, make sure the end of the pipe protrudes further than the width of the rollers. Once the blade engages the pipe, turn the grip clockwise again 1/4 of a turn.

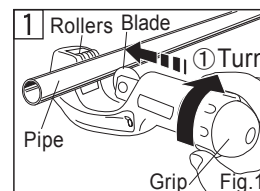

- 2 Rotate the cutter back and forth 2 or 3 times through 90° (see Fig.4 on reverse side) then fully one time to make a cutting guideline.

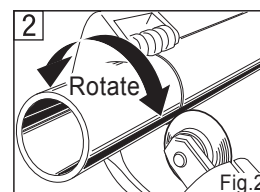

- 3 Then turn the grip slowly, (1/8 of a turn for every 3 or 4 rotations of the cutter) and keep rotating the cutter as you gradually cut deeper into the pipe.

- Avoid cutting too quickly or the pipe may become distorted and the life of the blades reduced.
- By attaching a special blade (sold separately) you can also cut copper (annealed or unannealed) and brass pipes.

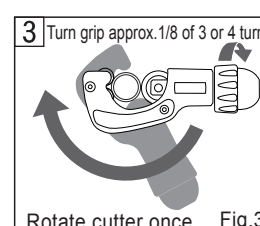

■ Specifications

Application	Thin wall Stainless Steel Pipes
Cutting capacity	External Diam. 5 - 34 mm
Weight (main unit)	350g
Blade diameter	φ30
Rollers	625ZZ
Spare Blade Code No.	424233, 424284
Optional Extras	Blade for Coated and Nude Copper pipes (Code No. 424237)

REX INDUSTRIES CO.,LTD.

Overseas Sales Dept. & Factory

1-9-3, Hishiya-Higashi, Higashi-Osaka 578-0948 Japan
Tel. +81-(0)72-961-9820 Fax +81-(0)72-961-9878
www.rexind.co.jp

4V410-E1
0808D01000

Operating Instructions

REX RB Tube Cutter Model N42P

Code No.
427842

For Coated and Nude Copper Pipes

For safe, efficient use, read these instructions carefully before use. Use the device correctly and for its intended use only. Keep these instructions in a safe place so that you can refer to them at any time.

⚠ WARNING

- Use the cutter only for the types of tubes described in these instructions. Use with other pipes, or for purposes other than the intended use, may result in an accident or damage to the cutter.
- Always inspect the cutter before use. If you find anything wrong, do not use until repairs have been made.
- When cutting pipes, make sure the blade doesn't touch your hand. Never place your fingers between the blade and the pipe.
- Avoid dropping the cutter either when using or carrying it.
- Be sure to remove any water or flux from the cutter. Failure to do so could result in the bearings becoming rusty and malfunctioning.

■ Instructions

- 1 Place the pipe on the cutter between the rollers and the blade as shown in Fig. 1. When doing so, make sure the end of the pipe protrudes further than the width of the rollers. Once the blade engages the pipe, turn the grip clockwise again 1/4 of a turn.

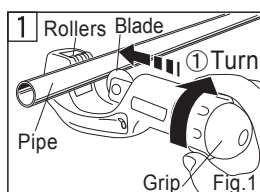

- 2 Rotate the cutter back and forth 2 or 3 times through 90° (see Fig.4 on reverse side) then fully one time to make a cutting guideline.

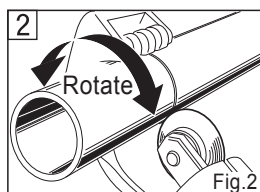

- 3 Then turn the grip slowly, (1/8 of a turn for every 3 or 4 rotations of the cutter) and keep rotating the cutter as you gradually cut deeper into the pipe.

- Avoid cutting too quickly or the pipe may become distorted and the life of the blades reduced.
- By attaching a special blade (sold separately) you can also cut copper (annealed or unannealed) and brass pipes.

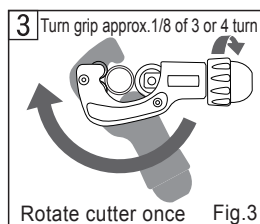

■ Specifications

Application	Coated and Nude Copper Pipes
Cutting capacity	External Diam. 6 - 42 mm
Weight (main unit)	400g
Blade diameter	φ32
Rollers	625ZZ
Spare Blade Code No.	424237
Optional Extras	Blade for Thin wall Stainless Steel Pipes (Code No.424233, 424284)

REX INDUSTRIES CO.,LTD.

Overseas Sales Dept. & Factory

1-9-3, Hishiya-Higashi, Higashi-Osaka 578-0948 Japan
Tel. +81-(0)72-961-9820 Fax +81-(0)72-961-9878
www.rexind.co.jp

4V450-E3
1304D01000

Operating Instructions

REX RB Tube Cutter Model N42S

Code No.
427642

For Thin wall Stainless Steel Pipes

For safe, efficient use, read these instructions carefully before use. Use the device correctly and for its intended use only. Keep these instructions in a safe place so that you can refer to them at any time.

⚠ WARNING

- Use the cutter only for the types of tubes described in these instructions. Use with other pipes, or for purposes other than the intended use, may result in an accident or damage to the cutter.
- Always inspect the cutter before use. If you find anything wrong, do not use until repairs have been made.
- When cutting pipes, make sure the blade doesn't touch your hand. Never place your fingers between the blade and the pipe.
- Avoid dropping the cutter either when using or carrying it.
- Be sure to remove any water or flux from the cutter. Failure to do so could result in the bearings becoming rusty and malfunctioning.

■ Instructions

- 1 Place the pipe on the cutter between the rollers and the blade as shown in Fig. 1. When doing so, make sure the end of the pipe protrudes further than the width of the rollers. Once the blade engages the pipe, turn the grip clockwise again 1/4 of a turn.

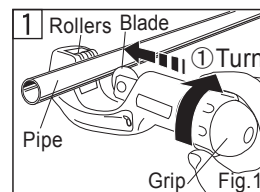

- 2 Rotate the cutter back and forth 2 or 3 times through 90° (see Fig.4 on reverse side) then fully one time to make a cutting guideline.

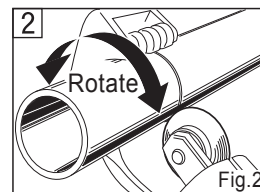

- 3 Then turn the grip slowly, (1/8 of a turn for every 3 or 4 rotations of the cutter) and keep rotating the cutter as you gradually cut deeper into the pipe.

- Avoid cutting too quickly or the pipe may become distorted and the life of the blades reduced.
- By attaching a special blade (sold separately) you can also cut copper (annealed or unannealed) and brass pipes.

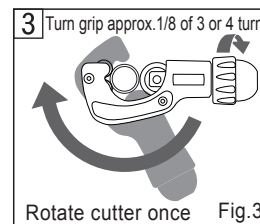

■ Specifications

Application	Thin wall Stainless Steel Pipes
Cutting capacity	External Diam. 6 - 42 mm
Weight (main unit)	400g
Blade diameter	φ30
Rollers	625ZZ
Spare Blade Code No.	424233, 424284
Optional Extras	Blade for Coated and Nude Copper pipes (Code No. 424237)

REX INDUSTRIES CO.,LTD.

Overseas Sales Dept. & Factory

1-9-3, Hishiya-Higashi, Higashi-Osaka 578-0948 Japan
Tel. +81-(0)72-961-9820 Fax +81-(0)72-961-9878
www.rexind.co.jp

4V420-E1
0901D01000

Operating Instructions

REX RB Tube Cutter Model N67P

Code No.
427867

For Coated and Nude Copper Pipes

For safe, efficient use, read these instructions carefully before use. Use the device correctly and for its intended use only. Keep these instructions in a safe place so that you can refer to them at any time.

⚠ WARNING

Use the cutter only for the types of tubes described in these instructions. Use with other pipes, or for purposes other than the intended use, may result in an accident or damage to the cutter.

Always inspect the cutter before use. If you find anything wrong, do not use until repairs have been made.

When cutting pipes, make sure the blade doesn't touch your hand. Never place your fingers between the blade and the pipe.

Avoid dropping the cutter either when using or carrying it.

Be sure to remove any water or flux from the cutter. Failure to do so could result in the bearings becoming rusty and malfunctioning.

■ Instructions

- Place the pipe on the cutter as shown in Fig. 1, making sure the end of the pipe protrudes further than the width of the rollers. Push in the grip until the rollers and blade lightly contact the pipe.

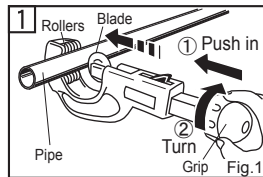

- At that point, turn the grip clockwise again 1/4 of a turn. Rotate the cutter back and forth 2 or 3 times through 90° (see Fig. 5 on reverse side) then once more through one complete rotation to make a cutting guideline.

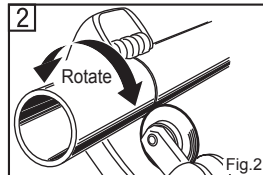

- Then turn the grip slowly, (1/8 of a turn for every 3 or 4 rotations of the cutter) and keep rotating the cutter as you gradually cut deeper into the pipe.

- Avoid cutting too quickly or the pipe may become distorted and the life of the blades reduced.

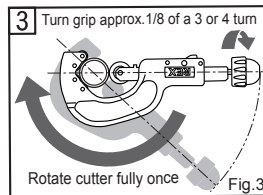

- Press the lever on the underside of the cutter (see Fig. 4) to release the blade.

⚠ WARNING

When you release the blade, the grip springs back quite forcefully. To avoid injury, hold the cutter away from your face or other parts of your body.

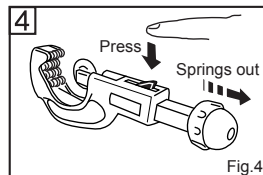

- By attaching a special blade (sold separately) you can also cut copper (annealed or unannealed) and brass pipes

■ Specifications

Application	Coated and Nude Copper Pipes
Cutting capacity	External Diam. 12 ~ 67 mm
Weight (main unit)	870g
Blade diameter	φ32
Rollers	625ZZ
Spare Blade Code No.	424237
Optional Extras	Blade for Thin Wall Stainless Steel Pipes (Code No. 424233, 424284)

REX INDUSTRIES CO.,LTD.

Overseas Sales Dept. & Factory
1-9-3, Hishiya-Higashi, Higashi-Osaka 578-0948 Japan
Tel. +81-(0)72-961-9820 Fax +81-(0)72-961-9878
www.rexind.co.jp

4V460-E1
0808D01000

Operating Instructions

REX RB Tube Cutter Model N67S

Code No.
427667

For Thin wall Stainless Steel Pipes

For safe, efficient use, read these instructions carefully before use. Use the device correctly and for its intended use only. Keep these instructions in a safe place so that you can refer to them at any time.

⚠ WARNING

Use the cutter only for the types of tubes described in these instructions. Use with other pipes, or for purposes other than the intended use, may result in an accident or damage to the cutter.

Always inspect the cutter before use. If you find anything wrong, do not use until repairs have been made.

When cutting pipes, make sure the blade doesn't touch your hand. Never place your fingers between the blade and the pipe.

Avoid dropping the cutter either when using or carrying it.

Be sure to remove any water or flux from the cutter. Failure to do so could result in the bearings becoming rusty and malfunctioning.

■ Instructions

- Place the pipe on the cutter as shown in Fig. 1, making sure the end of the pipe protrudes further than the width of the rollers. Push in the grip until the rollers and blade lightly contact the pipe.

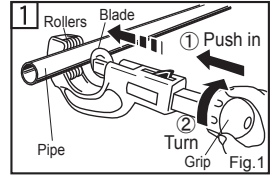

- At that point, turn the grip clockwise again 1/4 of a turn. Rotate the cutter back and forth 2 or 3 times through 90° (see Fig. 5 on reverse side) then once more through one complete rotation to make a cutting guideline.

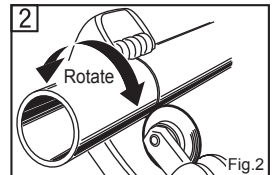

- Then turn the grip slowly, (1/8 of a turn for every 3 or 4 rotations of the cutter) and keep rotating the cutter as you gradually cut deeper into the pipe.

- Avoid cutting too quickly or the pipe may become distorted and the life of the blades reduced.

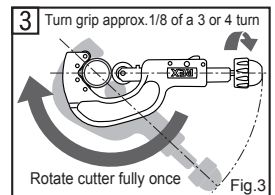

- Press the lever on the underside of the cutter (see Fig. 4) to release the blade.

⚠ WARNING

When you release the blade, the grip springs back quite forcefully. To avoid injury, hold the cutter away from your face or other parts of your body.

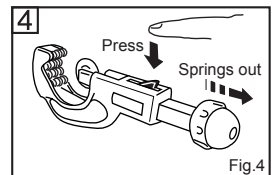

- By attaching a special blade (sold separately) you can also cut copper (annealed or unannealed) and brass pipes

■ Specifications

Application	Thin Wall Stainless Steel Pipes
Cutting capacity	External Diam. 12 - 67 mm
Weight (main unit)	870g
Blade diameter	φ30
Rollers	625ZZ
Spare Blade Code No.	424233, 424284
Optional Extras	Blade for Coated and Nude Copper Pipes (Code No. 424237)

REX INDUSTRIES CO.,LTD.

Overseas Sales Dept. & Factory
1-9-3, Hishiya-Higashi, Higashi-Osaka 578-0948 Japan
Tel. +81-(0)72-961-9820 Fax +81-(0)72-961-9878
www.rexind.co.jp

4V430-E2
1107D01000